

**PROJECT :**

**PROPOSED PARTLY BASEMENT + GROUND + 13 & PARTLY BASEMENT + GROUND + 2 STORIED RESIDENTIAL BUILDING.**

NAME OF OWNER(S): 1. M/S. PRAKASH DISTILLERY & CHEMICALS CO. LTD.  
REPRESENTED BY SRI BIJAY SAHA

2. M/S. CANON PAPER INDUSTRIES PVT.LTD.  
REPRESENTED BY SRI AJIT SAHA.

3. M/S. SAHAJI FINANCE PVT.LTD.  
REPRESENTED BY SRI GOUTAM SAHA

4. M/S. BHOJNARAIN TEA COMPANY LTD.  
REPRESENTED BY SRI PROSENUJIT SAHA.

LOCATION : DAGAPUR, SILIGURI.

SCHEDULE OF LAND :

SCHEDULE OF LAND :

MOUZA - BARAGHARIA;  
J.L.NO. - 82;  
PLOT NO. - R.S. - 312  
L.R. - 424, 425, 426, 427, 428, 429

PARGANA - PATHARGHATA  
P.S. - MATIGARA;  
DIST. - DARJEELING;

KHATIAN NO. - R.S. - 6/1  
L.R. - 75,

RESIDENT ARCHITECT:



**GREEN ARCHITECTURE CONSULTING ENGINEERS PVT. LTD.**  
1ST FLOOR, B. R. AMBEDKAR COMPLEX,  
HILL CART ROAD, SILIGURI - 734003.

PRINCIPAL ARCHITECT: SOHAN NILKANTH

SCALE:- AS MENTIONED

INSCAPE  
308 AAROHI COMPLEX,  
VIJAY CHAR RASTA  
AHMEDABAD 380009  
TEL: +91 79 40320556  
EMAIL: inscape2003@gmail.com

SHEET NO. :- 04  
CKD. BY:- K. K. ROY

DRAWN BY:- MOFIKUL ISLAM

ASSOCIATE ARCHITECT:  
PRIYANK THAKERSHY, ANALOG STUDIO

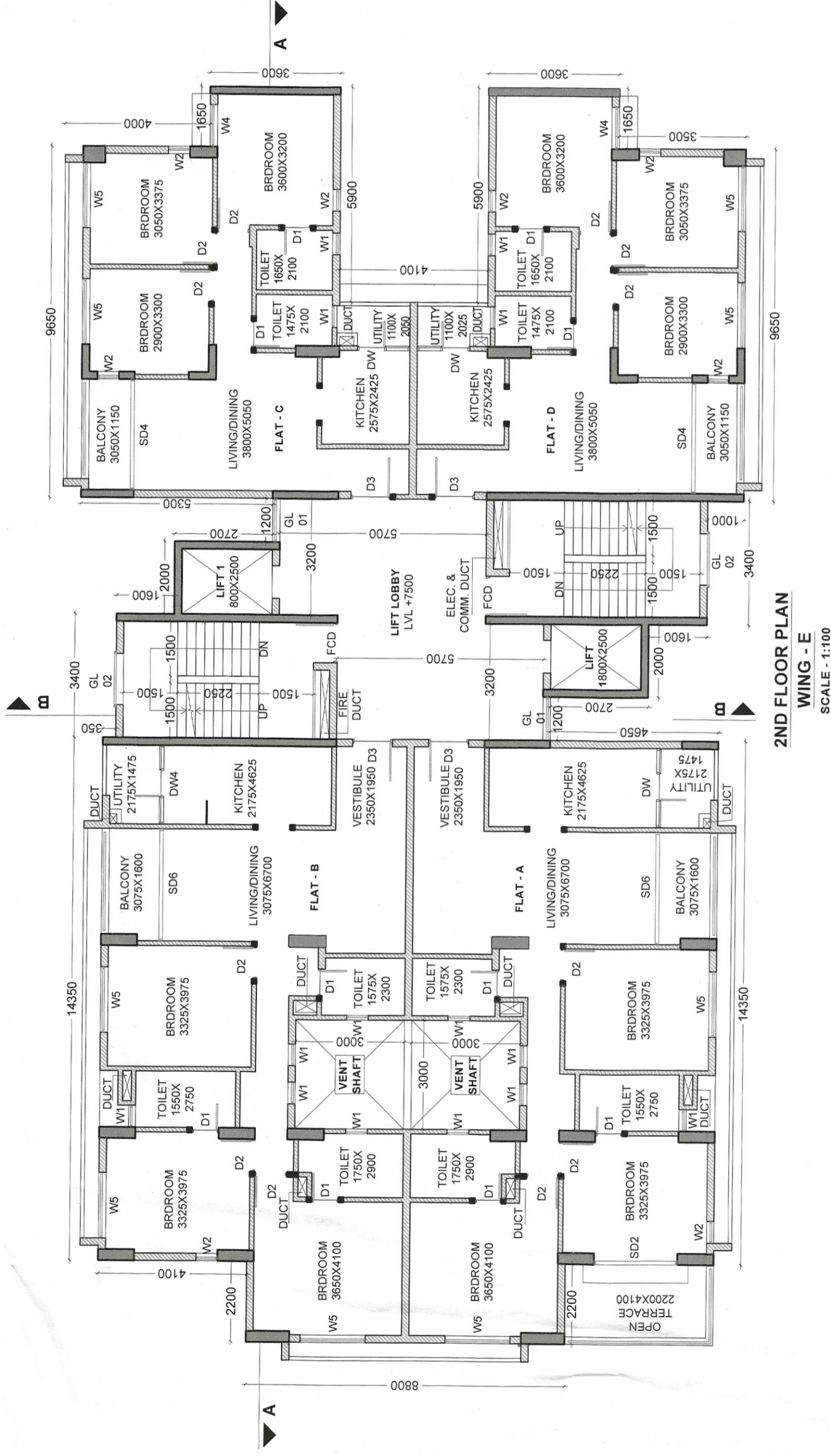

**2ND FLOOR PLAN  
WING - E  
SCALE - 1:100**

**DECLARATION OF OWNER**

I DO HEREBY DECLARE THAT THE BUILDING PROPOSED FOR CONSTRUCTION SHALL BE SUPERVISED BY THE B.A. / L.B.S. SIGNING THE BUILDING PLAN APPLICATION OR IN HIS ABSENCE BY ANY OTHER B.A. / L.B.S. OF THE APPROPRIATE CATEGORY AND AS APPROVED BY THE AUTHORITY.

*(Signature)*

**AJAY AGARWAL,**

Constituted Attorney of :-

- Prakash Distillery & Chemical co. Pvt. Ltd.
- Bhojnarain Tea Co. Ltd.
- Canon Paper Industries Pvt. Ltd.
- Sahaji Finance Pvt. Ltd.

SIGNATURE OF OWNER(S)

**DECLARATION OF ARCHITECT / L.B.S.**

I DO HEREBY CERTIFY THAT THE FOUNDATION AND SUPER STRUCTURE HAVE BEEN MADE BY ME IN ACCORDANCE WITH THE LATEST NATIONAL BUILDING CODE OF INDIA AND I. S. CODES AND ALSO CERTIFY THAT THE STRUCTURE IS SAFE AND STABLE IN ALL RESPECT AND I SHALL BE HELD FULLY RESPONSIBLE FOR ANY DAMAGE OR FAILURE HAPPENED DURING CONSTRUCTION AND THEREAFTER BEYOND THE DATE OF TAKING OCCUPANCY OR POSSESSION OF THE BUILDING IF THERE IS NO DEVIATION OR VIOLATION OF THE SANCTIONED OR APPROVED BUILDING PLAN.

*(Signature)*  
**RIYA BISWAS (B.Arch)**  
CA/2019/112919

SIGNATURE OF ARCHITECT/L.B.S

**DECLARATION OF STRUCTURAL ENGINEER**

THE STRUCTURAL DESIGN AND DRAWING OF BOTH FOUNDATION AND SUPER STRUCTURE OF THE BUILDING HAS BEEN MADE BY ME CONSIDERING ALL POSSIBLE LOADS INCLUDING THE SEISMIC LOAD AS PER THE "NATIONAL BUILDING CODE" OF INDIA AND CERTIFIED THAT IT IS SAFE AND STABLE IN ALL RESPECT.  
MOREOVER I/WE SHALL BE HELD RESPONSIBLE FOR ANY STRUCTURE DAMAGE/FAILURE HAPPENED DURING CONSTRUCTION PERIOD AND THERE AFTER BEYOND DATE OF TAKING OCCUPANCY CERTIFICATE.

*(Signature)*

**SANJIV J. PAREKH**  
M.E.(STRUCT.), M.E.(CONST. ENG)  
B.C.E., FIE-(F-018202-4)  
E.S.E. NO. 104(I) K.M.C.  
STRUC/ENGR/1-27 S.M.C.

SIGNATURE OF STRUCTURAL ENGINEER